

## 2W 6GHz SMA – Coaxial Attenuator

### Design Features

- ◆ High RF performance, ultra-competitive price.
- ◆ Custom design available upon request.
- ◆ Military, space and commercial applications.
- ◆ Guaranteed for one year standard.

### RF Characteristics

Model Number	Freq. Range	Power	Attenuation Value	Attenuation Tolerance	VSWR Max	Connector Type	Impedance
UIYCA2AS6A1	DC-6GHz	2W	1 dB	±0.5 dB	1.2	SMA-M / SMA-F	50 Ω
UIYCA2AS6A2		2W	2 dB	±0.5 dB	1.2	SMA-M / SMA-F	50 Ω
UIYCA2AS6A3		2W	3 dB	±0.5 dB	1.2	SMA-M / SMA-F	50 Ω
UIYCA2AS6A5		2W	5 dB	±0.5 dB	1.2	SMA-M / SMA-F	50 Ω
UIYCA2AS6A6		2W	6 dB	±0.5 dB	1.2	SMA-M / SMA-F	50 Ω
UIYCA2AS6A10		2W	10 dB	±0.6 dB	1.2	SMA-M / SMA-F	50 Ω
UIYCA2AS6A15		2W	15 dB	±0.6 dB	1.2	SMA-M / SMA-F	50 Ω
UIYCA2AS6A20		2W	20 dB	±0.6 dB	1.2	SMA-M / SMA-F	50 Ω
UIYCA2AS6A25		2W	25 dB	±0.8 dB	1.2	SMA-M / SMA-F	50 Ω
UIYCA2AS6A30		2W	30 dB	±0.8 dB	1.2	SMA-M / SMA-F	50 Ω
UIYCA2AS6A40		2W	40 dB	±1.5 dB	1.2	SMA-M / SMA-F	50 Ω
UIYCA2AS6A50		2W	50 dB	±1.5 dB	1.2	SMA-M / SMA-F	50 Ω
UIYCA2AS6A60		2W	60 dB	±1.8 dB	1.2	SMA-M / SMA-F	50 Ω

- <sup>2</sup> List are specify frequency range and other ranges available.  
<sup>2</sup> Please enter below information when inquiry and mark \* is must.  
 \* 1. Power handling, Attenuation Value  
 2. Connect type (SMA Male/ Female, N Male/ Female, etc.)  
 3. Other special request if have (VSWR, Temperature, Dimension, etc.)

### Mechanical Drawing

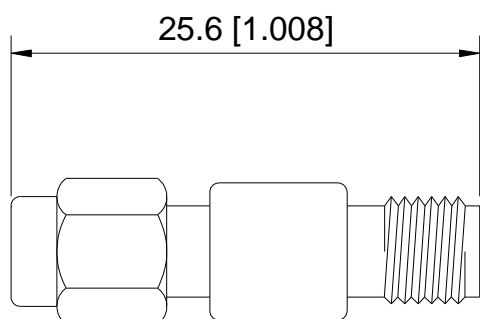

1~40dB

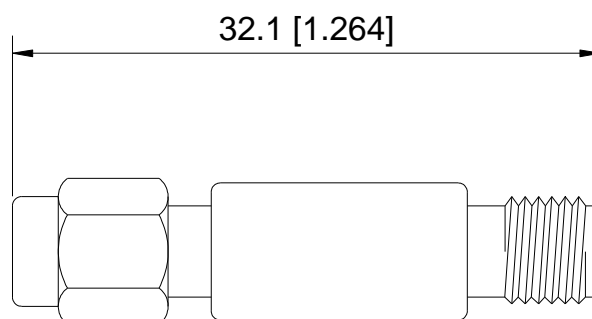

50~60dB

Unit: mm/ inch, General part tolerance is ±2% unless otherwise stated.

Ver. 5

3/F, No 9, Xiangyin Rd, Longgang District, Shenzhen 518116, China.

Web: [www.uiy.com](http://www.uiy.com)

Tel: +86-755-25999990 +86-755-25999909

Fax: +86-755-25999959

E-mail: [sales@uiy.com](mailto:sales@uiy.com)