

0.5W 6GHz SMA – Coaxial Attenuator

Design Features

- ◆ High RF performance, ultra-competitive price.
- ◆ Custom design available upon request.
- ◆ Military, space and commercial applications.
- ◆ Guaranteed for one year standard.

RF Characteristics

Model Number	Freq. Range	Power	Attenuation Value	Attenuation Tolerance	VSWR Max	Connector Type	Impedance
UIYCA05AS6A1	DC-6GHz	0.5W	1 dB	±0.5 dB	1.2	SMA-M / SMA-F	50 Ω
UIYCA05AS6A2		0.5W	2 dB	±0.5 dB	1.2	SMA-M / SMA-F	50 Ω
UIYCA05AS6A3		0.5W	3 dB	±0.5 dB	1.2	SMA-M / SMA-F	50 Ω
UIYCA05AS6A5		0.5W	5 dB	±0.5 dB	1.2	SMA-M / SMA-F	50 Ω
UIYCA05AS6A6		0.5W	6 dB	±0.5 dB	1.2	SMA-M / SMA-F	50 Ω
UIYCA05AS6A10		0.5W	10 dB	±0.6 dB	1.2	SMA-M / SMA-F	50 Ω
UIYCA05AS6A15		0.5W	15 dB	±0.6 dB	1.2	SMA-M / SMA-F	50 Ω
UIYCA05AS6A20		0.5W	20 dB	±0.6 dB	1.2	SMA-M / SMA-F	50 Ω
UIYCA05AS6A25		0.5W	25 dB	±0.8 dB	1.2	SMA-M / SMA-F	50 Ω
UIYCA05AS6A30		0.5W	30 dB	±0.8 dB	1.2	SMA-M / SMA-F	50 Ω
UIYCA05AS6A40		0.5W	40 dB	±1.5 dB	1.2	SMA-M / SMA-F	50 Ω
UIYCA05AS6A50		0.5W	50 dB	±1.5 dB	1.2	SMA-M / SMA-F	50 Ω
UIYCA05AS6A60		0.5W	60 dB	±1.8 dB	1.2	SMA-M / SMA-F	50 Ω

- ² List are specify frequency range and other ranges available.
² Please enter below information when inquiry and mark * is must.
 * 1. Power handling, Attenuation Value
 2. Connect type (SMA Male/ Female, N Male/ Female, etc.)
 3. Other special request if have (VSWR, Temperature, Dimension, etc.)

Mechanical Drawing

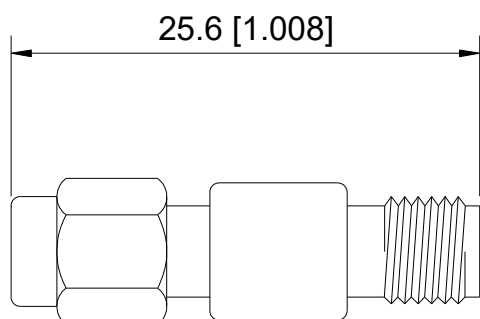

1~40dB

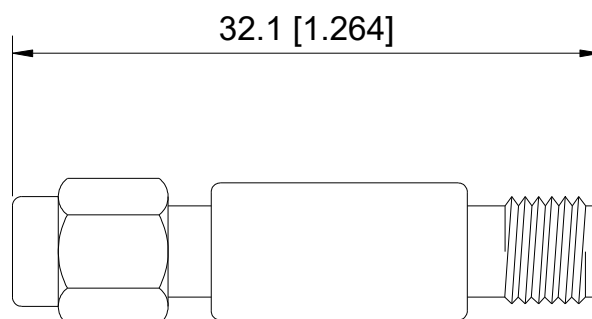

50~60dB

Unit: mm/ inch, General part tolerance is ±2% unless otherwise stated.

Ver. 5

3/F, No 9, Xiangyin Rd, Longgang District, Shenzhen 518116, China.

Web: www.uiy.com

Tel: +86-755-25999990 +86-755-25999909

Fax: +86-755-25999959

E-mail: sales@uiy.com