

0.5W 3GHz SMA – Coaxial Attenuator

Design Features

- ◆ High RF performance, ultra-competitive price.
- ◆ Custom design available upon request.
- ◆ Military, space and commercial applications.
- ◆ Guaranteed for one year standard.

RF Characteristics

Model Number	Freq. Range	Power	Attenuation Value	Attenuation Tolerance	VSWR Max	Connector Type	Impedance
UIYCA05AS3A1	DC-3GHz	0.5W	1 dB	±0.5 dB	1.15	SMA-M / SMA-F	50 Ω
UIYCA05AS3A2		0.5W	2 dB	±0.5 dB	1.15	SMA-M / SMA-F	50 Ω
UIYCA05AS3A3		0.5W	3 dB	±0.5 dB	1.15	SMA-M / SMA-F	50 Ω
UIYCA05AS3A5		0.5W	5 dB	±0.5 dB	1.15	SMA-M / SMA-F	50 Ω
UIYCA05AS3A6		0.5W	6 dB	±0.5 dB	1.15	SMA-M / SMA-F	50 Ω
UIYCA05AS3A10		0.5W	10 dB	±0.6 dB	1.15	SMA-M / SMA-F	50 Ω
UIYCA05AS3A15		0.5W	15 dB	±0.6 dB	1.15	SMA-M / SMA-F	50 Ω
UIYCA05AS3A20		0.5W	20 dB	±0.6 dB	1.15	SMA-M / SMA-F	50 Ω
UIYCA05AS3A25		0.5W	25 dB	±0.8 dB	1.15	SMA-M / SMA-F	50 Ω
UIYCA05AS3A30		0.5W	30 dB	±0.8 dB	1.15	SMA-M / SMA-F	50 Ω
UIYCA05AS3A40		0.5W	40 dB	±1.5 dB	1.15	SMA-M / SMA-F	50 Ω
UIYCA05AS3A50		0.5W	50 dB	±1.5 dB	1.15	SMA-M / SMA-F	50 Ω
UIYCA05AS3A60		0.5W	60 dB	±1.8 dB	1.15	SMA-M / SMA-F	50 Ω

- ² List are specify frequency range and other ranges available.
² Please enter below information when inquiry and mark * is must.
 * 1. Power handling, Attenuation Value
 2. Connect type (SMA Male/ Female, N Male/ Female, etc.)
 3. Other special request if have (VSWR, Temperature, Dimension, etc.)

Mechanical Drawing

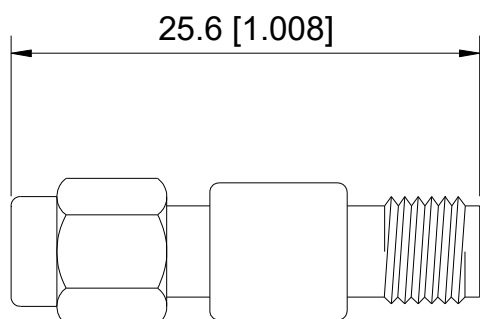

1~40dB

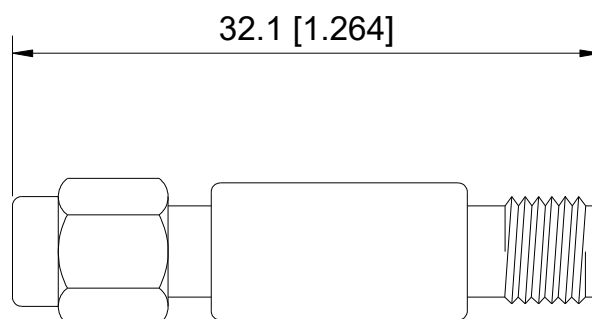

50~60dB

Unit: mm/ inch, General part tolerance is $\pm 2\%$ unless otherwise stated.

Ver. 5